

Lumux Lighting

SL600L -

Step Light with rectangular louver trim.
ETL Listed for wet Locations.

REV : D

Project :

Type:

Date:

Agency:

Distributor:

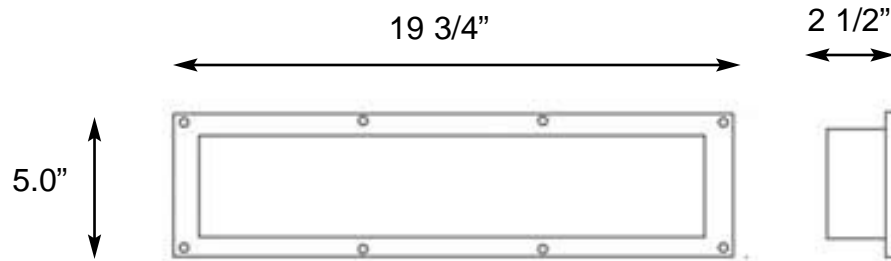

Construction :

Low Cooper die cast aluminum. Vandal resistance stainless steel screws. Silicon gasketed for weather tight operation.

Electrical :

Voltage: 120 / 277 V
Lamp: Incandescent T10, Compact Fluorescent, LED
Socket : A19 , 2G11
Ballast : Class P. Electronic Ballast.

Diffuser:

Opal Glass

Finish :

Polyester Powder Coat

Installation :

A Polymer Housing is provided with the fixture as a Rough- In box. Opening size is :
18 3/16" x 4 3/16" x 4.0" (Length, Width, Depth)

Ordering Guide:

	<u>Lamp</u>	/	<u>Voltage</u>	/	<u>Finish</u>	/	<u>Options:</u>
SL600L/	T10 - 24Watt- Long CFL (FT24) LED (1600 Lumen)		120 277		Black White Silver Bronze RAL- Optional		